

# The Willow

3 bedroom home

827 sq.ft.



## Ground floor

### Lounge

4244mm x 4470mm 13'11" x 14'8"

### Kitchen / Dining

5176mm x 2732mm 13'0" x 8'11"

### WC

900mm x 1727mm 2'11" x 5'8"

## First floor

### Bedroom 1

2498mm x 4232mm 8'2" x 13'10"

### Bedroom 2

2987mm x 3005mm 9'9" x 9'10"

### Bedroom 3

2588mm x 3144mm 8'6" x 10'4"

### Bathroom

2100mm x 1825mm 6'10" x 6'0"

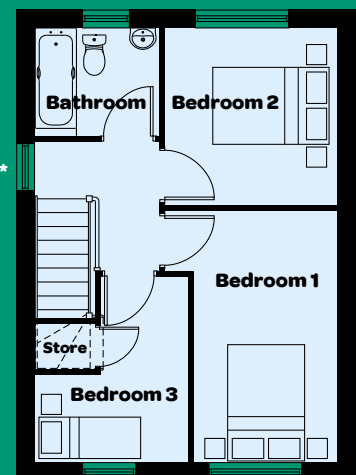
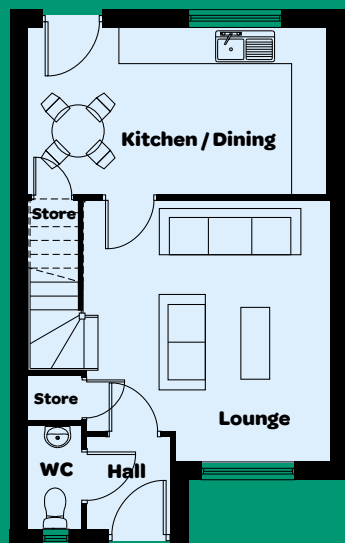

\* Window where applicable

All properties are freehold.

0151 256 0900 [parklandsliving.co.uk](https://www.parklandsliving.co.uk)

Plans are not drawn to scale. Room layouts are provisional, sizes are approximate and are for illustration purposes only and do not form any part of a contract. Elevations may vary, images are for illustration purposes only.

 **Parklands**